

# ZION EYE MASSAGER

## OPERATION MANUAL



Dear customer thank you for purchasing eye massager, Please read Manual carefully before using the device to ensure proper operate and use.If you have any question, please feel free contact us .Many thanks.

## ▶ CONTENTS

---

Product Features.....	2
Product Components.....	2
Product Charging.....	3
Preparation.....	4
Usage method.....	5
Storage and Transportation.....	6
Cleaning and Keeping.....	6
Matters needing attention.....	7
Using matters attention.....	7
Common matters and methods.....	8
Technical parameter.....	8

## ▶ PRODUCT FEATURES

Automatic timing

Intelligent air pressure

180°folding

Wave band vibration

Heating

Rechargeable

Intelligent voice

Meditation music

## ▶ PRODUCT COMPONENTS

### Device

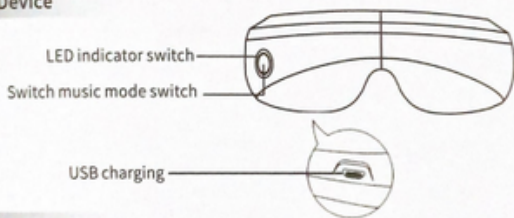

### Accessories

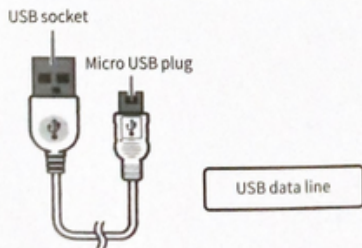

## Product Charging

### Battery charging

1. Please use the power adapter comes with the package.
2. The USB plug of USB data wire must be use into the USB socket of power adapter.
3. The power adapter must be into electric outlet.
4. The Micro USB plug of USB data wire must be into Micro USB electric outlet of product.

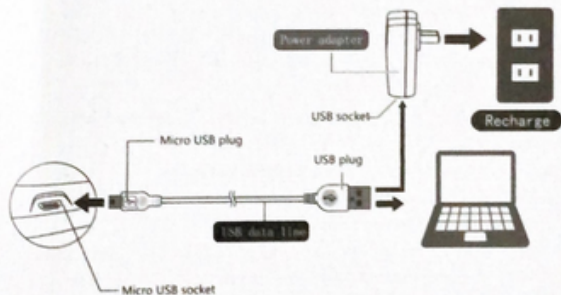

### ⚠ Warm Tips

In the charging process, the indicator light FLASHES, when the charging is completed, the light KEEPS LIGHT.

Once the product is charged when working, the product automatically will stop working.

The charging time are kept 3-5 hours.

Once the charging is completed, please disconnect the power adapter.

## Product Charging

### Battery charging

1. Please use the power adapter comes with the package.
2. The USB plug of USB data wire must be use into the USB socket of power adapter.
3. The power adapter must be into electric outlet.
4. The Micro USB plug of USB data wire must be into Micro USB electric outlet of product.

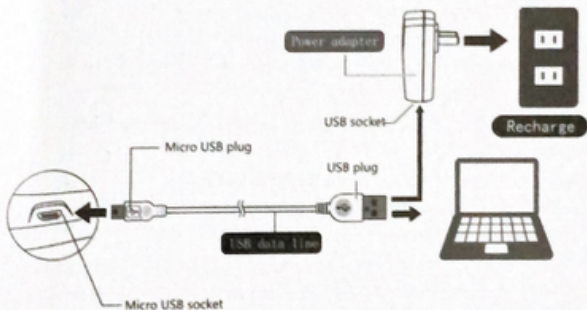

### ⚠ Warm Tips

In the charging process, the Indicator light FLASHES, when the charging is completed, the light KEEPS LIGHT.

Once the product is charged when working, the product automatically will stop working.

The charging time are kept 3-5 hours.

Once the charging is completed, please disconnect the power adapter.

## ▶ PREPARATION BEFORE USE

### Wear device

make the cloth cover assigned with the eyes,with the main part,make the elasticband adjusted to the most comfortable position,and adjust the position of the upper and the lower side of themain machine to the most comfortable position.



### ⚠ Attention

Remove the glasses,contact lenses,hairpin,hair ornaments before use to avoid the discomfort.

When your hands are wet,do not touch the product.

Do not drop and trample the product.

## USING METHOD

### Turn on the device :

The finger always press "○" for 2 seconds, turn on the product.  
After turning on, the blue light keeps light, and default enter into automatic mode.

### Warm Tips

Each massage modes with timing control, once over 15 minutes, it would stop working automatically

### Turn on/off the music:

The finger continuously press "○" for twice, turn on the music.  
The finger continuously press "○" for twice, turn off the music.

### Change The Massage Mode

Press the "○" less than 1 second to change massage mode.  
The 5 modes as follows and each mode for 15 minutes when you operated.

Automatic mode = pneumatic massage + hot compress massage + vibration massage + music

Eye protection mode = pneumatic massage + hot compress massage + music

Vitality mode = pneumatic massage + vibration massage + music

Comfort mode = Hot compress massage + Music

Sleep mode = pneumatic massage + music

(Note: Sometimes the patterns differ from the instructions due to the continuous updates of product versions)

## ▶ STORAGE AND TRANSPORTATION

---

Ideal environment temperature:-40°C-50°C

Relative humidity.<80%, keep good ventilation condition and away from direct sunshine and corrosive gases.

Transportation:The product has simple shockproof design and can be transported by air,railway,highway or ship,avoid rain,snow,impact and always keep the right side up.In case the storage period 3 month,please check and power it on for half an hour.

## ▶ CLEANING AND KEEPING

---

### **Cleaning**

Before cleaning ,power it off,unplug the power adapter from the socketPlease use the dry cloth to clean the surface of the product.

### **⚠ Warning:**

Be sure to turn off the power when cleaning

Do not use corrosive cleaning agents to clean the product,or it will make the product fade out and the product components subject to corrosion and cracking.

### **Keep method:**

For a long time no use,please use the dust cloth(owned) to cover,so as not to be covered with dust.

### **Notice:**

Do not place the product on the sun exposure or high temperature,so as not to make the product fade out.



## ▶ MATTERS NEEDING ATTENTION

---

1. Please read carefully, and understand all items of the instruction, operate product on the basis of it.
2. Do not use it who has eye disease. The product is not allowed to use for those person who had ever experienced eye surgery, glaucoma, cataract, detached retina and other serious eye disease.
3. Do not clean the product by water, and please keep cleaning by soaked with alcohol cotton.
4. Do not dismantle the product by yourself.
5. The product are attached with heating on its surface, the one who are not sensitive with heating should be more careful.
6. Pupil, the disabled and the old should use it with the guidance of the adult.
7. The product are designed for personal health care and massage, not instead drugs or medical equipment.
8. Do not dismantle, crack, press the internal lithium battery or throw it to water, if there is serious expand, do not use it.
9. Do not use it once the product are soaking with water.
10. Do not place the product to high temperature environment, for it attached to rechargeable lithium battery.
11. Those person who are with sensitive skin, facial allergic dermatitis, facial parts are placed with plastic materials should use the product with the guidance of doctor.

## ▶ USING MATTERS ATTENTION

---

1. Before using, remove the glasses, contact lenses, hairpin, hair ornaments.
2. Do not turn it on until wear it on eye, so as to avoid air bag over pressure damage.
3. Do not use it on high temperature and humid environment.
4. Avoid strong sunlight and gas corrosion.
5. Do not use it when driving or walking.
6. Please use the matching power adapter.
7. Please close your eye when using it.
8. Your eye may blurred when first use it, but it will be clear after 1-3 minutes.

## COMMON PROBLEMS AND METHODS

NO.	Problems encountered	Problem cause	Solve methods
1	some noise when operate	it is the usual sound madeby inflatable air pump.Bleed valve. Cloth coverfriction	no need for any measure
2	Automatic shutdown afterturn on	not enough electric inlithium battery	advice recharge
3	sfail to turn on the machine	not enough electric inlithium	advice recharge
4	Indicator light is not brightwhen recharging	USB port are in bad contact	unplugUSB cable
		power pack are in badcontact	be sure to are in good contact
5	the pressure is too weak weak	pnot enough electric inlithium battery	advice recharge

## TECHNICAL PARAMETR

### Product parameter:

Product item: Eye massager

Product model:BY-EM1018

RInput voltage :AC110-240V~50Hz

Rated voltage: DC 5V 1A

Battery capacity :1200mAh

### Packing List:

Eye massager    USB cable    Manual

## Product Qualification Certificate

Product Name : Wireless Bluetooth Eye Massager

Product Model : AR-206

Date of manufacture : \_\_\_\_\_

Examination clerk : \_\_\_\_\_

Inspection conclusion : Qualified

版本号:V1.5

